

## **Installation Note**

---

### **HP 8560 Series, HP 8590 Series Spectrum Analyzers and HP E4900A Spectrum Monitoring System Rack Mount Kit**

**Option 909 Rack Mount kit, HP part number 5062-4840  
(includes rack flange/handle kit, HP part number 5062-3985)**

**Option 908 Rack Mount kit, HP part number 5062-4841  
(includes rack flange kit, HP part number 5062-3979)**

**Rack Slide kit, HP part number 1494-0060**



**HP Part Number 5962-5074 Supersedes: 5958-7057  
Printed in USA December 1994**

**Notice.**

The information contained in this document is subject to change without notice.

Hewlett-Packard makes no warranty of any kind with regard to this material, including but not limited to, the implied warranties of merchantability and fitness for a particular purpose. Hewlett-Packard shall not be liable for errors contained herein or for incidental or consequential damages in connection with the furnishing, performance, or use of this material.

© Copyright Hewlett-Packard Company 1994  
All Rights Reserved. Reproduction, adaptation, or translation without prior written permission is prohibited, except as allowed under the copyright laws.  
1400 Fountaingrove Parkway, Santa Rosa, CA 95403-1799, USA

**PRODUCTS AFFECTED:**

HP 8560 Series spectrum analyzer  
HP 8590 Series spectrum analyzer  
HP E4900A spectrum monitoring system

**SERIAL NUMBERS:**

0000A00000-9999A99999  
0000U00000-9999U99999

**OPTIONS:**

908 and 909

**TO BE PERFORMED BY:**

HP Service Center  
 Personnel Qualified by HP  
 HP Personnel On-site

**ESTIMATED INSTALLATION TIME:**

1.25 hours  
Add 0.25 hours if installing the slide kit

## Description

The following installation instructions apply to rack mount kits which mount the instrument in a rack with 482.6 mm (19 in.) spacing.

## Tools Required

Description	HP Part Number
7-mm nut driver	8710-1217
4-mm hex (Allen) wrench	8710-1755
Large #2 Pozidrive screwdriver	8710-0900
Small #1 Pozidrive screwdriver	8710-0899
Needlenose Pliers	8710-0595
TORX driver T-15	8710-1622

## Installation Kit Parts List

**Table 1. Rack Mount Kit**

HP Part Number	Quantity	Description
HP part number 5062-4840, Option 909 rack mount kit (includes HP part number 5062-3985, rack flange/handle Kit)		
0510-1148	7	Push on Retainer
0515-0049	5	Screw-M5 x 12MM-LG HX SKT HD
0515-0866	5	Screw-M3 x 8MM-PAN HD
0515-1090	9	Screw-M3.5 x 8MM-PAN HD
0515-1234	9	Screw-M3.5 x 8MM-FLT HD
0515-1331	17	Screw-M4 x 6MM-FLT HD
0535-0082	7	Nut with Lockwasher M4
2190-0587	5	Lockwasher M5
3050-0894	5	Flatwasher M5
5002-0637	1	Rear Support
5002-0639	1	Panel-Dress
5002-0638	1	Subpanel
5021-8407	1	Frame-Front
5021-5808	1	Frame-Rear
5021-5836	4	Corner Strut
5062-3985	1	Flange Handle Kit
8710-1755	1	Hex Key, 4MM
9320-6209	1	Label
5962-5074	1	Installation note
HP part number 5062-4841, Option 908 rack mount kit (includes HP part number 5062-3979, rack flange kit)		
0510-1148	7	Push on Retainer
0515-0049	5	Screw-M5 x 12MM-LG HX SKT HD
0515-0866	5	Screw-M3 x 8MM-PAN HD
0515-1090	9	Screw-M3.5 x 8MM-PAN HD
0515-1234	9	Screw-M3.5 x 8MM-FLT HD
0515-1331	17	Screw-M4 x 6MM-FLT HD
0535-0082	7	Nut with Lockwasher M4
2190-0587	5	Lockwasher M5
3050-0894	5	Flatwasher M5
5002-0637	1	Rear Support
5002-0639	1	Panel-Dress
5002-0638	1	Subpanel
5021-8407	1	Frame-Front
5021-5808	1	Frame-Rear
5021-5836	4	Corner Strut
5062-3979	1	Flange Kit
8710-1755	1	Hex Key, 4MM
9320-6209	1	Label
5962-5074	1	Installation note

**Table 2. Rack Slide Kit**

<b>HP Part Number</b>	<b>Quantity</b>	<b>Description</b>
HP part number 1494-0060, rack slide kit		
	2	Slides (Not sold separately)
0515-0949	4	Screw-Mach M5 × 0.8 14MM-LG PAN-HD
0515-1013	4	Screw-Mach M5 × 0.7 12MM-LG PAN-HD
0515-0909	4	Screw-Mach M4 × 0.7 12MM-LG PAN-HD
0535-0080	8	Unistrut Nut M4 × 0.7

---

## **Safety Considerations**

---

**Warning**      **Before you disassemble the instrument, turn the power switch OFF and unplug the instrument. Failure to unplug the instrument can result in personal injury.**

---

**Caution**      Electrostatic discharge (ESD) can damage or destroy electronic components. All work on electronic assemblies should be performed at a static-safe workstation. Refer to the documenttton that pertains to your instrument for information about static-safe workstations and ordering static-safe accessories.

---

---

## Installation Procedure

1. Remove the instrument's four front frame bumpers ①. See Figure 1.

**Caution** Use caution when placing the instrument dress panel face down on its finished surface. Use a soft cloth to protect the assembly from scratches or damage.

---

2. Place the kit's subpanel ② face down on a clean flat surface such as a desk top.
3. Place the instrument face down into the subpanel. Be sure to orient the instrument in relation to the subpanel mount holes ⑨ as illustrated in Figure 1.
4. Attach the subpanel to the top of the instrument's front frame using four M3 × 0.5 × 8 mm pan-head screws ③. The screws mount into the front bumper mounting holes.
5. Use a 4-mm hex key to unscrew the four screws ④ attaching the instrument cover assembly ⑤ to the instrument. Pull the cover assembly off to the rear of the instrument.
6. Remove the two screws ⑥ attaching the rear feet ⑦ to the cover assembly and remove the rear feet.

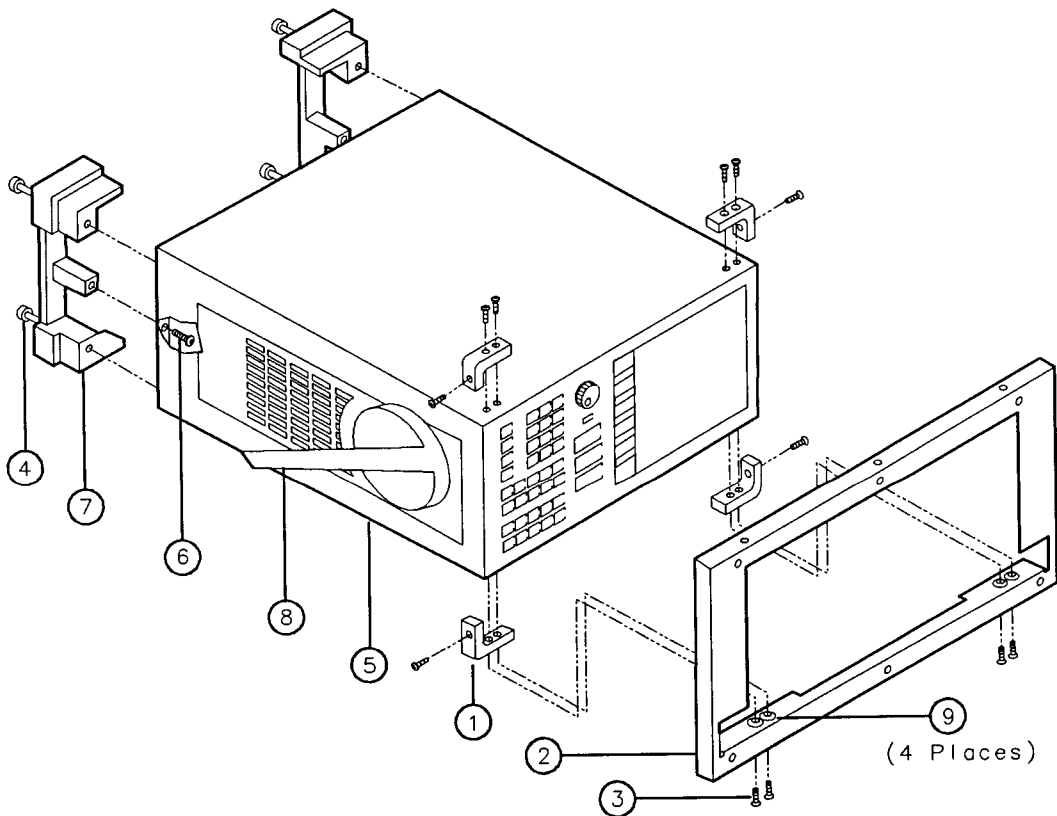

**Figure 1. Installing the Rack Kit Subpanel**

7. Remove the two screws attaching the bail handle assembly ⑧ to the cover assembly. The screws are located on the inside of the cover assembly. Pull each handle side straight out from the side of the cover assembly.

---

**Caution**

When replacing the instrument cover, use caution to protect the instrument's cable assemblies from damage.

---

- Slide the cover assembly back on the instrument. If the cover assembly has a seam, locate the seam at the bottom side of the instrument. If the cover is seamless, locate the cover's air vent holes over the bottom side of the instrument.

Make sure that the instrument's cover assembly fits into the groove in the front frame all the way around the front frame.

- Replace the four screws and washers and attach the instrument cover to the rear frame.

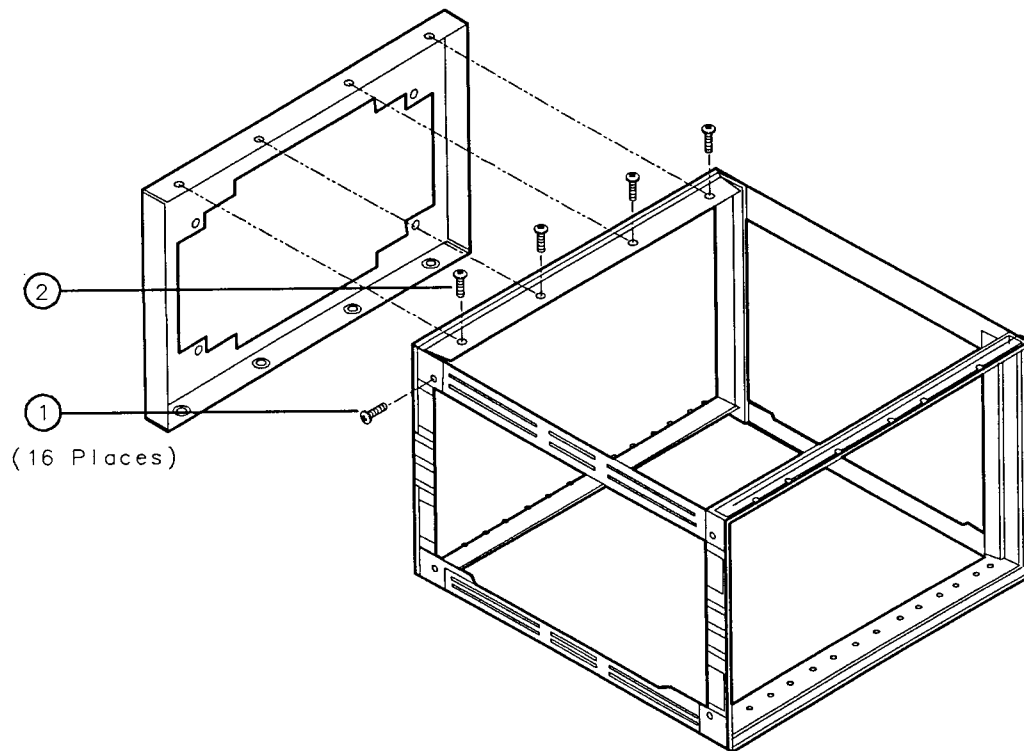

**Figure 2. Assembling the Rack Frame**

- Assemble the rack kit frame as illustrated in Figure 2, using 16 (four on each side) M4 × 0.7 × 6 mm flat-head screws (see ① in Figure 2) and eight M3.5 × 0.6 × 8 mm pan-head screws. (See ② in Figure 2.)

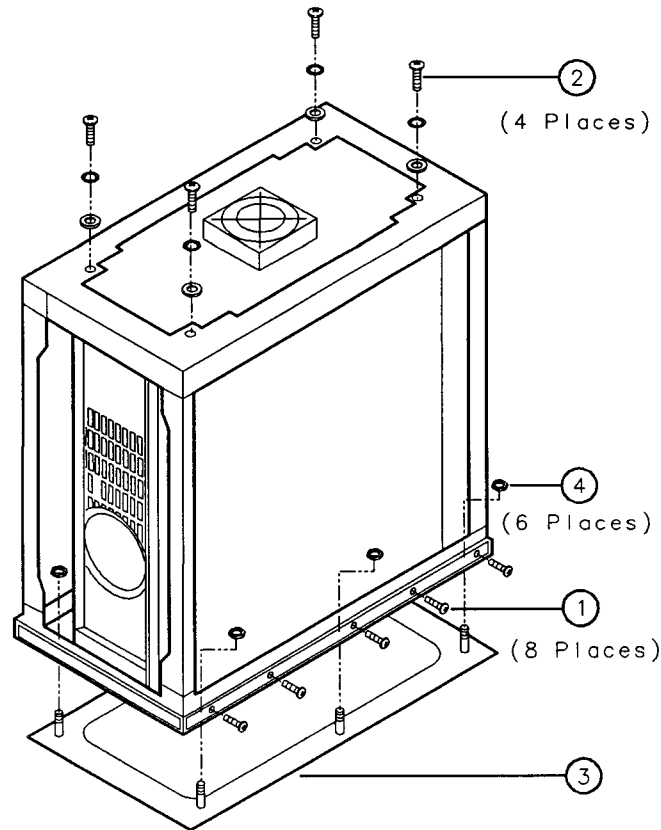

**Figure 3. Attaching the Rack Frame to the Instrument**

11. Place the rack frame over the instrument as illustrated in Figure 3. The rack front frame should have a deeper groove on the bottom side.
12. Attach the rack frame to the front support using eight M3.5 × 0.6 × 8 mm flat-head screws ①. See Figure 3.
13. Attach the rack frame to the rear of the instrument using four M5 × 0.8 × 12-mm socket head cap screws, lock washers, and flat washers. Use the hex key to torque to 50 inch-pounds. See ② in Figure 3.
14. Tip assembly on one side. Install the dress panel ③, and secure it with six nuts ④. Use a 7-mm driver. Torque to 6 inch-pounds maximum. *Do not* overtorque.



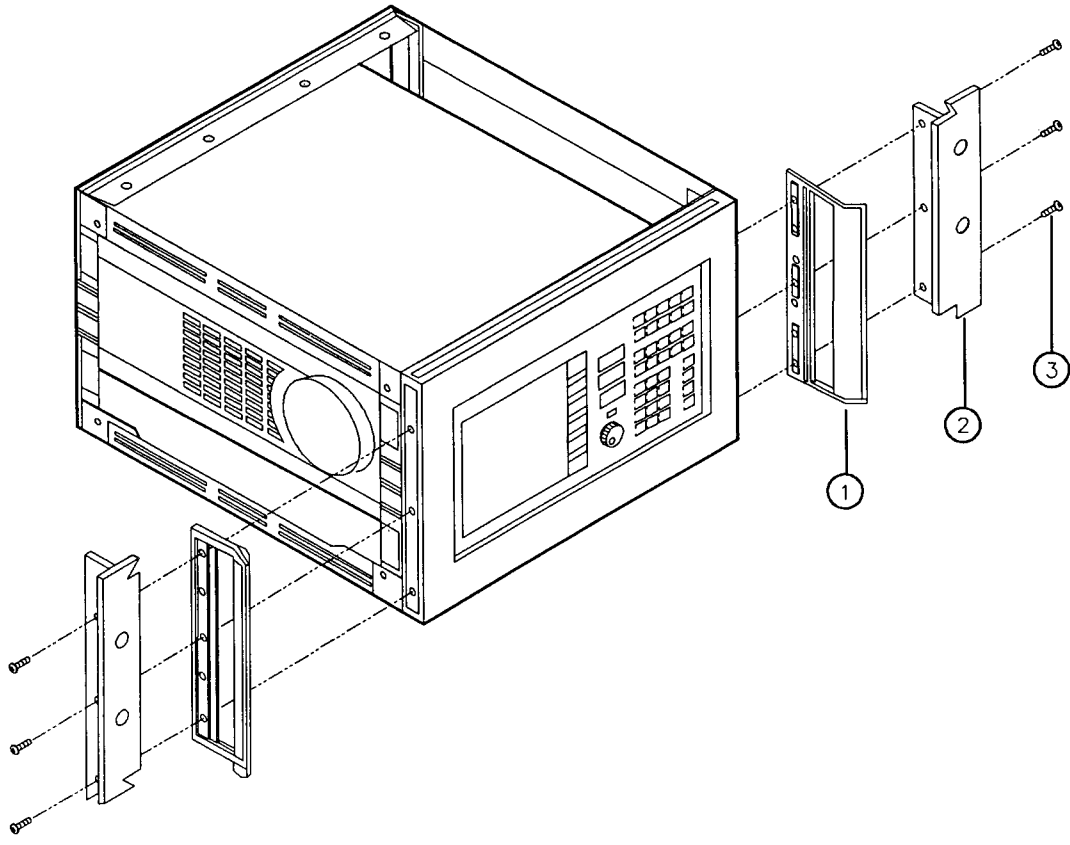

**Figure 4. Installing Rack Flanges and Handles**

15. Place the instrument in its operating position. See Figure 4. For HP part number 5062-4840 kits, mount the handles ① and rack flanges ② to the rack frame using six M4 × 0.7 × 16 mm pan-head screws ③ HP part number 5062-4841 kits do not come with handles; the rack flanges mount directly to the rack frame using six M4 × 0.7 × 10 mm pan-head screws.
16. The instrument is now ready to mount into the systems rack.

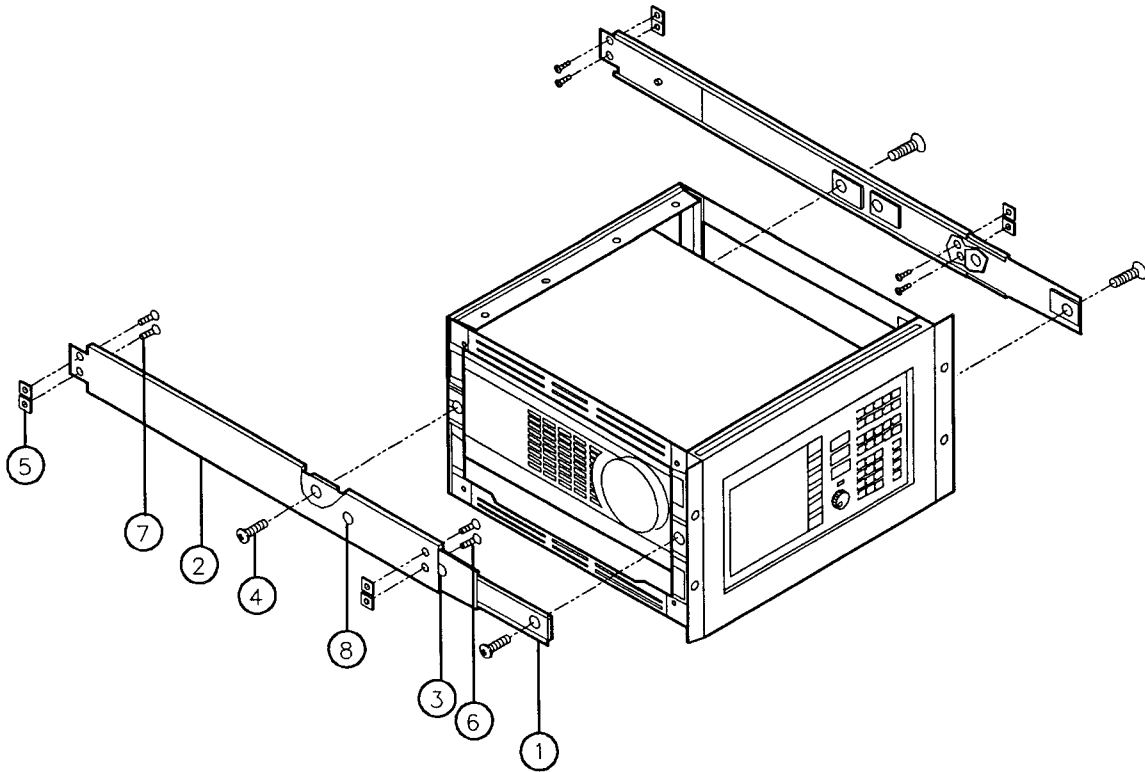

**Figure 5. Installing the Rack Slide Kit**

### **Installing the Rack Slide Kit**

1. Install the HP part number 5062-4841 or part number 5062-4840 rack mount kit as described above.
2. Expand each rack slide to its full length.
3. Separate the inner slide member ① from the outer slide member ② by pressing release button ③ and pulling the inner slide member out. See Figure 5. Due to space considerations, Figure 5 does not show the rack slide extended to its full length.
4. Attach an inner slide member to each side of the rack mount frame using two M5 × 0.8 × 14 mm pan-head screws per side. See ④ in Figure 5.
5. Insert two unistrut nuts ⑤ in each of the four vertical columns of the systems rack.
6. Compress each outer-slide member to its shortest length, revealing the holes for screws ⑥. Release button ⑧ may have to be pressed.
7. Attach an outer slide member to each side of the systems rack using two M4 × 0.7 × 12 mm flat-head screws ⑥ in the front and two M4 × 0.7 × 12 mm pan-head screws ⑦ in the rear.
8. Place the instrument into the rack by sliding the inner slide members into the outer slide members. Use the release buttons, located on the slides, to enable complete compression of the slides.



Customer Order Number

Printed in USA      DECEMBER 1994

**\*\* For HP Internal Reference Only \*\***

Manufacturing Part Number

**5962-5074**

